

# 3 BIKE TOWING CARRIER

## Fold Down 2" Receiver

### INSTRUCTIONS:

1. The Towing Carrier requires no assembly.
2. Slide your Towing Carrier receiver arm onto your receiver hitch \* (as shown in diagram 1).
3. Fit rack as close to vehicle as possible.
4. Secure your Towing Carrier by tightening set screws.
5. Check to ensure rack is secure.
6. To remove top plate, undo captured knobs on your TowingCarrier. Remove top plate. Place bike top tubes in vinyl grooves so that they are balanced as shown in diagram 3. (Sloping top tube bicycles may sit on an angle\*\*).
7. After placing a maximum of 3 bikes on your Towing Carrier, replace top plate and tighten knobs evenly.

### INSTRUCTIONS FOR FOLDING THE RACK:

1. Remove all bikes and other equipment from the Fold Down Carrier. (Diagram 1)
2. Remove clip from upper 1/2" security pin and unlock. (Step 1&2)
3. Pull support tube firmly upwards until lower pin slides to top of its slot. (Step 3)
4. Let support tube rotate slowly back until support tube rests on stop plate. (Step 4)  
NOTE: DO NOT drop support tube or let it fall freely. Make sure that hands and fingers are clear of hinging area during operation.
5. To restore rack to upright position reverse procedure. Make sure that the lower pin is positioned all the way down in the slot. Replace upper 1/2" security pin and clip and engage lock pin. NEVER use the rack without security pin and clip in place.

### IMPORTANT NOTES:

1. Use a minimum Class III 2" receiver.
2. Alternate direction of handlebars when carrying 3 bikes (see bicycle mounting options).
3. To prevent the front wheels and handlebars from moving during transport, we recommend a nylon strap or standard bungee cord, routed through the wheel spokes and around the downtube of the bike frame.
4. To lock bikes onto your Towing Carrier, use a standard padlock through the holes in the top plates. We also recommend running a cable from the padlock through both wheels and back. This is to ensure quick release wheels cannot be removed. Your TowingCarrier may also be locked to the tow hitch with a padlock and cable or locking pin\*\*\* if desired.

\* Drawbar and tow ball not included. These are available at your local hitch shop.

\*\* See your retailer for a Rack Adaptor that will allow sloping tube bicycles to sit level on your Towing Carrier.

\*\*\* Ask your retailer about locking hitch pins.

### Using the Towing Carrier on a boat or travel trailer:

1. Rack failure through improper mounting will void rack warranty.
2. Minimum length 2" drawbar is 10". This depends on hitch recess length behind bumper.  
**WARNING - DRIVER BEWARE.** Ensure all other items near bikes and rack, such as battery, propane tank, etc., do not impede turning of vehicle with bikes and rack attached.
3. Severe risk of crushing bikes between trailer and vehicle if driver engages in too tight a radius turn! Bike or racks damaged due to misuse will not be covered by warranty.

Diagram 1

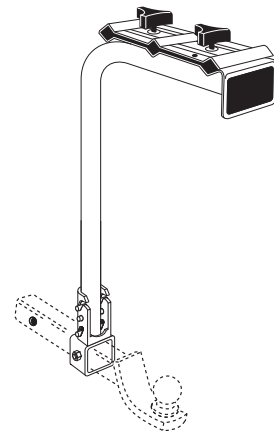

Diagram 2

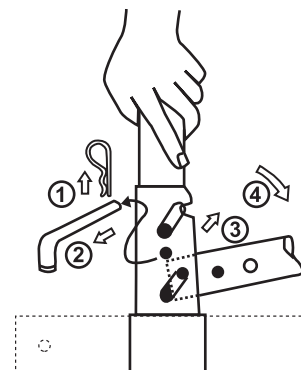
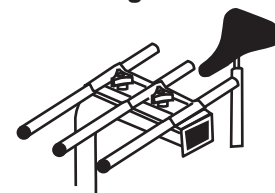
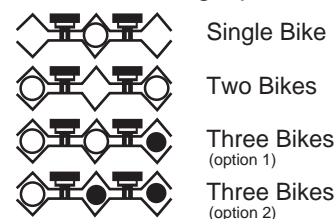

Diagram 3



### Bike Mounting Options



- Oversized Tube
- Standard Tube